

SD-01 ELEVATION: (VIEW INSIDE)
SCALE: 1:13

SD-01 SECTION:
THRU. SLIDING PANEL

SD-01 SECTION:
THRU. FIXED PANEL

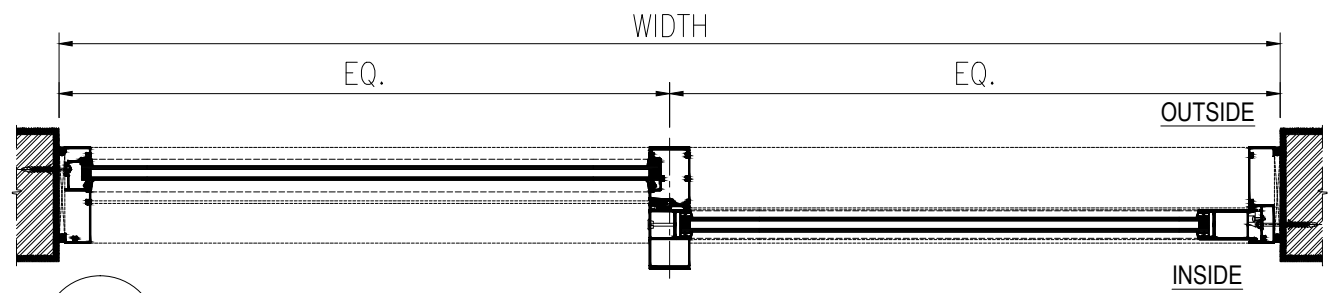

SD-01 PLAN:

*GENERAL NOTES:
1. ALL DIMENSION AND LEVELS ARE IN FEET INCH.
2. ALL DIMENSIONS ARE TO BE READ NOT MEASURED.
3. ALL ELEVATIONS VIEWED AS PER SHOWN.

REFERENCE DRAWINGS:

—	—	—
—	—	—
—	—	—
—	—	—
—	—	—
—	—	—
—	—	—
—	—	—
—	—	—
—	—	—

DESIGN DRAWING NO. REV. NO. DATE:

FACADE CONSULTANT:
JOSEPH B. CALLAGHAN, INC.
1617 John F. Kennedy Blvd
Suite 1655
Philadelphia, PA 19103
T: 215.665.0497

ARCHITECT DESIGN CONSULTANT:
KSS ARCHITECTS
Princeton | Philadelphia
337 Witherspoon Street
Princeton, NJ 08542
T: 609.921.1131

PROJECT:
UNCOMMON SCHOOL
ADDITION AND RENOVATION
NORTH STAR ACADEMY-571 18TH AVENUE
571 18TH AVENUE, NEWARK, NJ 07103
LOT 1, BLOCKS 358-359

CLIENT:
—
—

ISSUE

—	—	—	—
—	—	—	—
—	—	—	—
—	—	—	—
—	—	—	—
—	—	—	—
—	—	—	—
—	—	—	—
—	—	—	—
—	—	—	—

NO. DESCRIPTION: DATE: REV.BY

DISCIPLINE:

FACADE CONTRACTOR:
SIMSONA CORPORATION
2275 Research Boulevard
Suite 500
Rockville, MD 20850
Office: 301-774-0880
Cell: 301-408-8553, FAX: 301-260-0239
E-mail: raj@simsona.com

DRAWING TITLE:
SHOP DRAWING OF SLIDING DOOR (SD-01)
ONE FIXED ONE SLIDE

DRAWN:	CHECKED:	APPROVED:	PAGE NO.	PR. CODE:	
DINESH	RAJ.G	RAJ.G	001	22308	
DATE:	DATE:	DATE:	SHEET NO.	SCALE:	SIZE:
12 Dec,19	—	—	1 OF 14	AS SHOWN	A3

DRAWING NUMBER: **UNC/SCH-SIMSONA-AL-DWG-SD-0301** REV: **00**

STATUS: SAMPLE DRAWING

- *GENERAL NOTES:
1. ALL DIMENSION AND LEVELS ARE IN FEET INCH.
 2. ALL DIMENSIONS ARE TO BE READ NOT MEASURED.
 3. ALL ELEVATIONS VIEWED AS PER SHOWN.

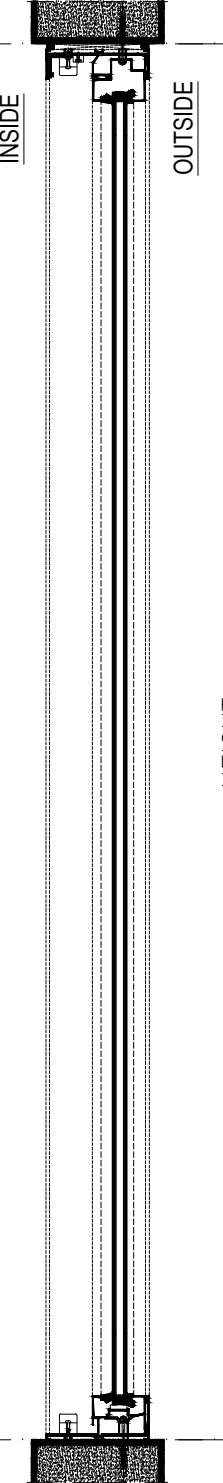
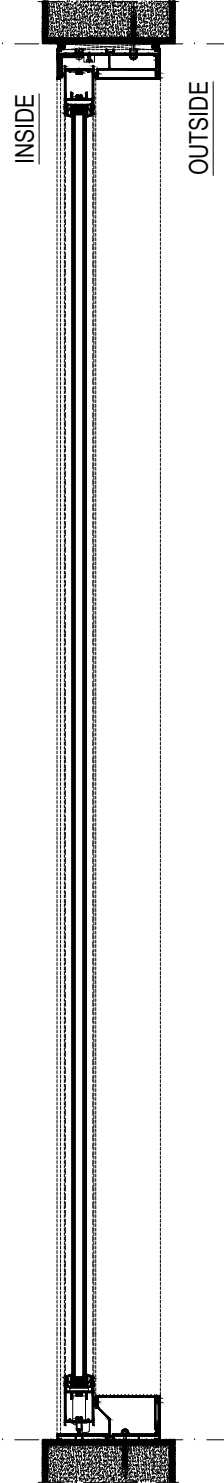
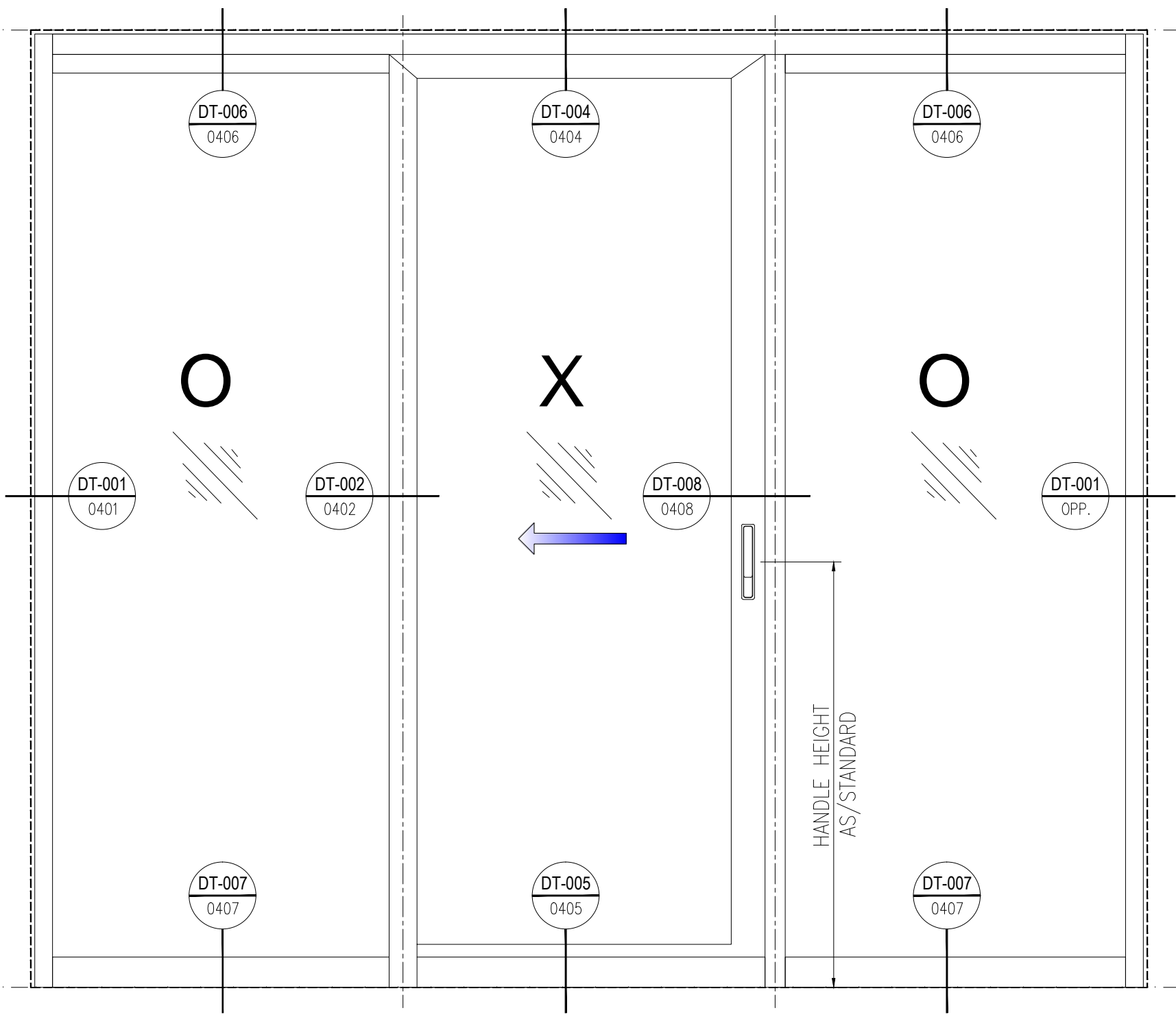

SD-02 ELEVATION: (VIEW INSIDE)
OPT-01 SCALE: 1:13

SD-02 SECTION:
THRU. SLIDING PANEL

SD-02 SECTION:
THRU. FIXED PANEL

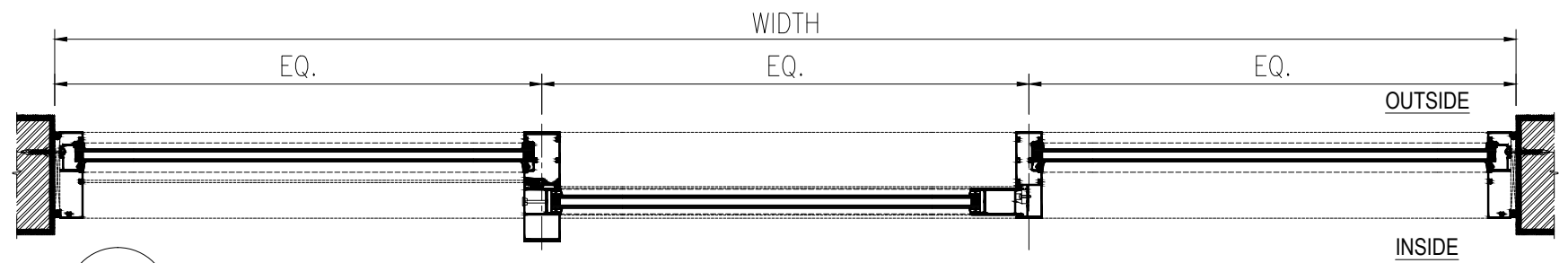

SD-02 PLAN:

REFERENCE DRAWINGS:

—	—	—
—	—	—
—	—	—
—	—	—
—	—	—
—	—	—
—	—	—
—	—	—
—	—	—
—	—	—

DESIGN DRAWING NO. REV. NO. DATE:

FACADE CONSULTANT:
JOSEPH B. CALLAGHAN, INC.
1617 John F. Kennedy Blvd
Suite 1655
Philadelphia, PA 19103
T: 215.665.0497

ARCHITECT DESIGN CONSULTANT:
KSS ARCHITECTS
Princeton | Philadelphia
337 Witherspoon Street
Princeton, NJ 08542
T: 609.921.1131

PROJECT:
UNCOMMON SCHOOL
ADDITION AND RENOVATION
NORTH STAR ACADEMY-571 18TH AVENUE
571 18TH AVENUE, NEWARK, NJ 07103
LOT 1, BLOCKS 358-359

CLIENT:
—
—

ISSUE

—	—	—	—
—	—	—	—
—	—	—	—
—	—	—	—
—	—	—	—
—	—	—	—
—	—	—	—
—	—	—	—
—	—	—	—
—	—	—	—

NO. DESCRIPTION: DATE: REV. BY

DISCIPLINE:

FACADE CONTRACTOR:
SIMSONA CORPORATION
2275 Research Boulevard
Suite 500
Rockville, MD 20850
Office: 301-774-0880
Cell: 301-408-8553, FAX: 301-260-0239
E-mail: raj@simsona.com

DRAWING TITLE:
SHOP DRAWING OF SLIDING DOOR (SD-02)
TWO FIXED ONE SLIDE

DRAWN:	CHECKED:	APPROVED:	PAGE NO.	PR. CODE:	
DINESH	RAJ.G	RAJ.G	002	22308	
DATE:	DATE:	DATE:	SHEET NO.	SCALE:	SIZE:
12 Dec,19	—	—	2 OF 14	AS SHOWN	A3

DRAWING NUMBER:
UNC/SCH-SIMSONA-AL-DWG-SD-0302

STATUS: SAMPLE DRAWING

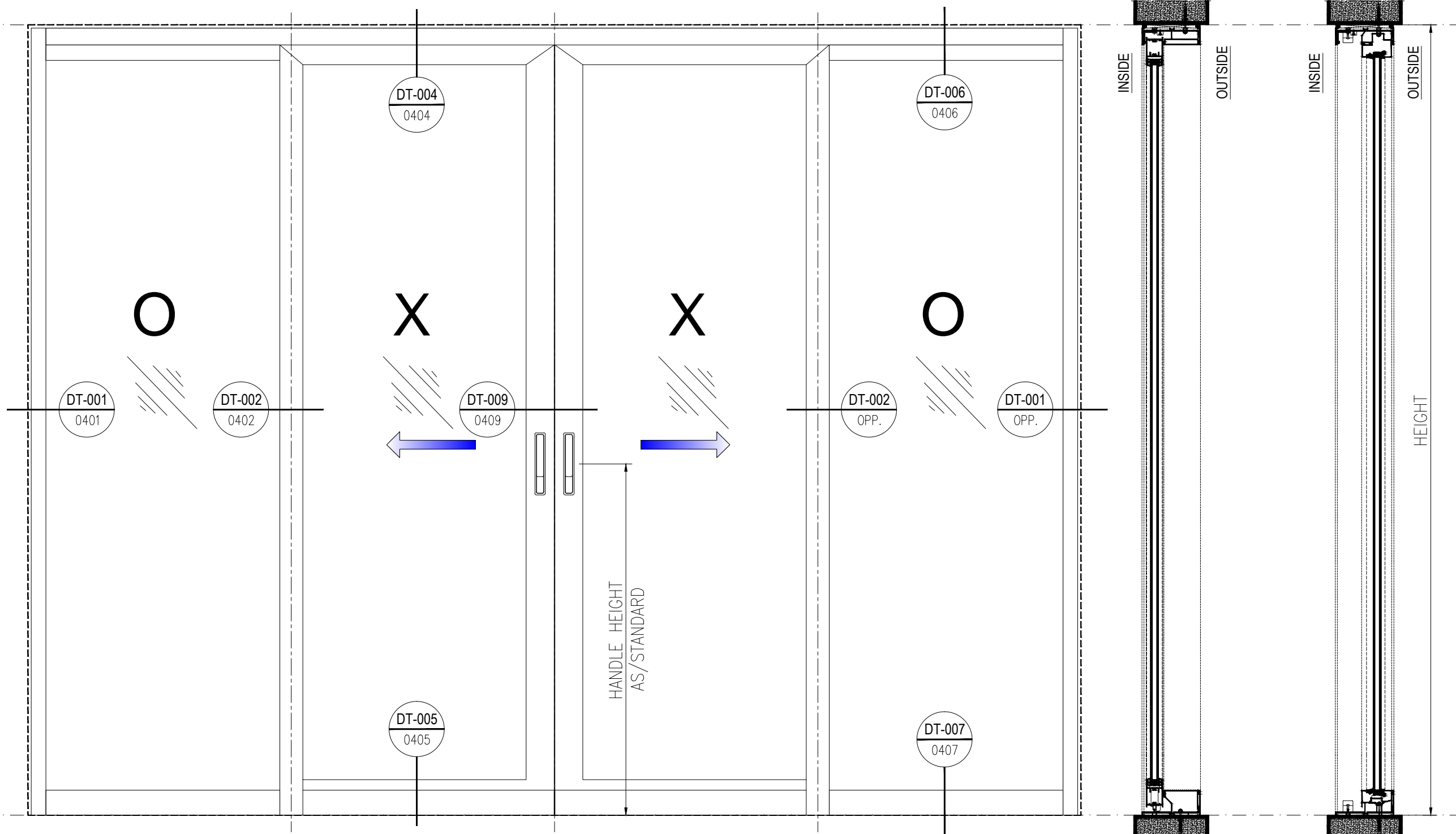

SD-03 ELEVATION: (VIEW INSIDE)
SCALE: 1:13

SD-03 SECTION:
THRU. SLIDING PANEL

SD-03 SECTION:
THRU. FIXED

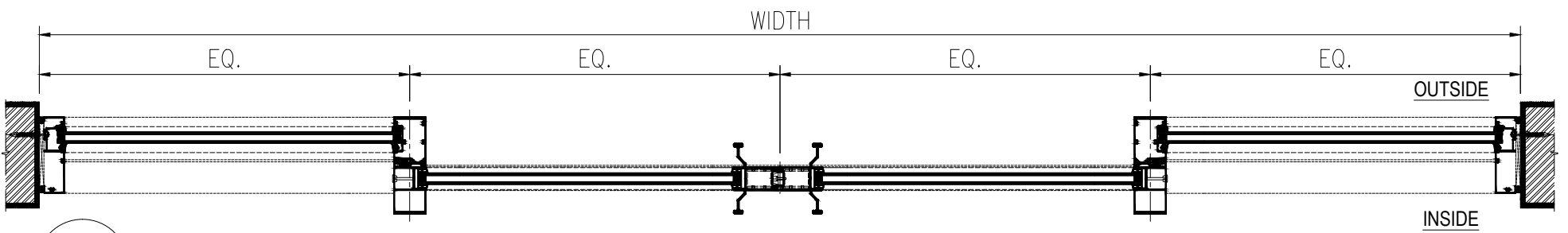

SD-03 PLAN:

*GENERAL NOTES:
1. ALL DIMENSION AND LEVELS ARE IN FEET INCH.
2. ALL DIMENSIONS ARE TO BE READ NOT MEASURED.
3. ALL ELEVATIONS VIEWED AS PER SHOWN.

REFERENCE DRAWINGS:

—	—	—
—	—	—
—	—	—
—	—	—
—	—	—
—	—	—
—	—	—
—	—	—

DESIGN DRAWING NO. REV. NO. DATE:

FACADE CONSULTANT:
JOSEPH B. CALLAGHAN, INC.
1617 John F. Kennedy Blvd
Suite 1655
Philadelphia, PA 19103
T: 215.665.0497

ARCHITECT DESIGN CONSULTANT:
KSS ARCHITECTS
Princeton | Philadelphia
337 Witherspoon Street
Princeton, NJ 08542
T: 609.921.1131

PROJECT:
UNCOMMON SCHOOL
ADDITION AND RENOVATION
NORTH STAR ACADEMY-571 18TH AVENUE
571 18TH AVENUE, NEWARK, NJ 07103
LOT 1, BLOCKS 358-359

CLIENT:
—

ISSUE

—	—	—
—	—	—
—	—	—
—	—	—
—	—	—
—	—	—
—	—	—
—	—	—
—	—	—
—	—	—

NO. DESCRIPTION: DATE: REV. BY

DISCIPLINE:

FACADE CONTRACTOR:
SIMSONA CORPORATION
2275 Research Boulevard
Suite 500
Rockville, MD 20850
Office: 301-774-0880
Cell: 301-408-8553, FAX: 301-260-0239
E-mail: raj@simsona.com

DRAWING TITLE:
SHOP DRAWING OF SLIDING DOOR (SD-03) TWO FIXED TWO SLIDE

DRAWN:	CHECKED:	APPROVED:	PAGE NO.	PR. CODE:	
DINESH	RAJ.G	RAJ.G	003	22308	
DATE:	DATE:	DATE:	SHEET NO.	SCALE:	SIZE:
12 Dec,19	—	—	3 OF 12	AS SHOWN	A3

DRAWING NUMBER:
UNC/SCH-SIMSONA-AL-DWG-SD-0303

STATUS: SAMPLE DRAWING

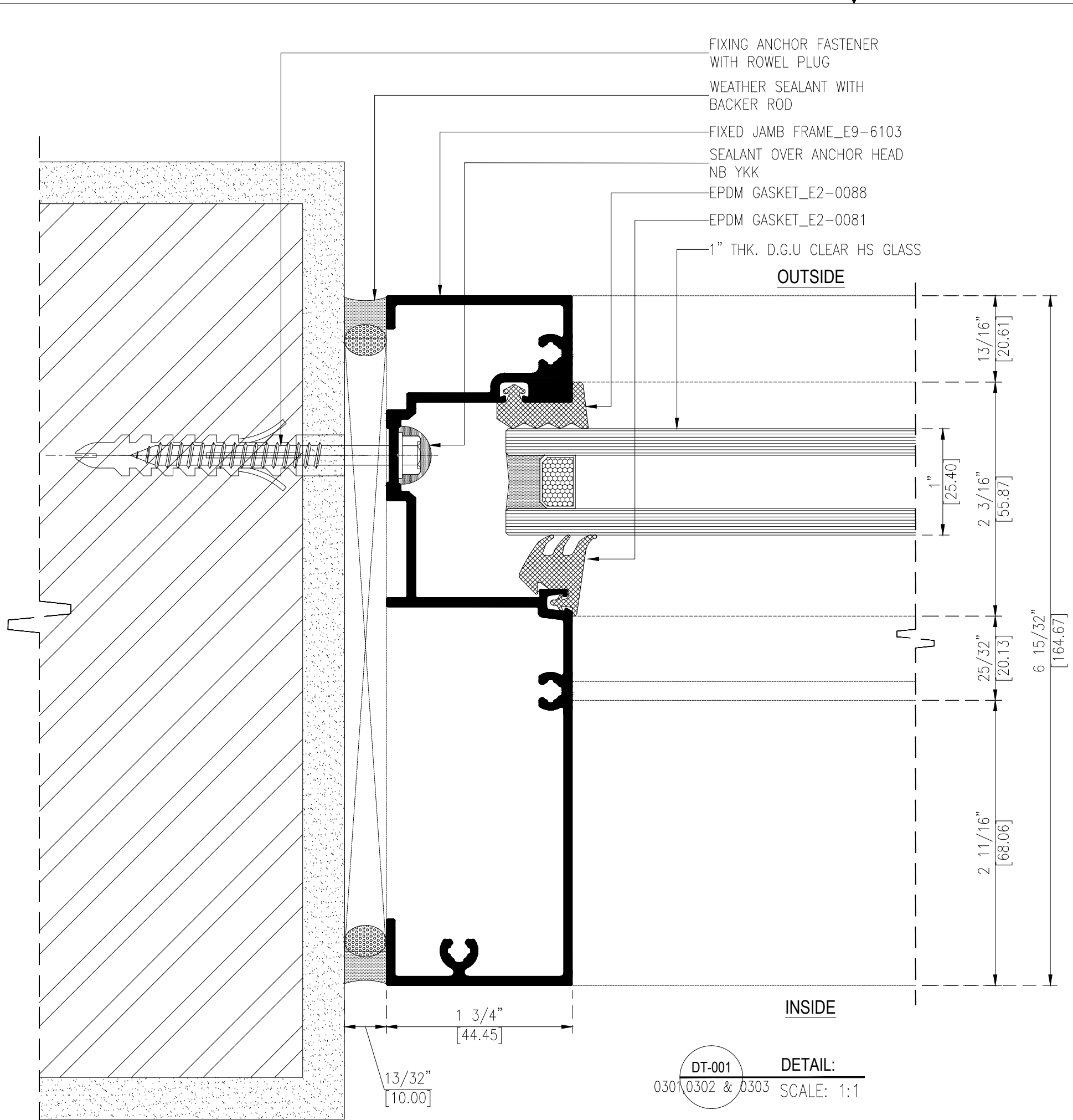

*GENERAL NOTES:
 1. ALL DIMENSION AND LEVELS ARE IN FEET INCH.
 2. ALL DIMENSIONS ARE TO BE READ NOT MEASURED.
 3. ALL ELEVATIONS VIEWED AS PER SHOWN.

REFERENCE DRAWINGS:

---	---	---
---	---	---
---	---	---
---	---	---
---	---	---
---	---	---
---	---	---
---	---	---

DESIGN DRAWING NO. REV. NO. DATE:

FACADE CONSULTANT:
JOSEPH B. CALLAGHAN, INC.
 1617 John F. Kennedy Blvd
 Suite 1655
 Philadelphia, PA 19103
 T: 215.665.0497

ARCHITECT DESIGN CONSULTANT:
KSS ARCHITECTS
 Princeton | Philadelphia
 337 Witherspoon Street
 Princeton, NJ 08542
 T: 609.921.1131

PROJECT:
UNCOMMON SCHOOL
 ADDITION AND RENOVATION
 NORTH STAR ACADEMY-571 18TH AVENUE
 571 18TH AVENUE, NEWARK, NJ 07103
 LOT 1, BLOCKS 358-359

CLIENT:
 --
 --

ISSUE

---	---	---	---
---	---	---	---
---	---	---	---
---	---	---	---
---	---	---	---
---	---	---	---
---	---	---	---
---	---	---	---
---	---	---	---

NO.	DESCRIPTION:	DATE:	REV. BY

DISCIPLINE:

FACADE CONTRACTOR:
 **SIMSONA CORPORATION**
 2275 Research Boulevard
 Suite 500
 Rockville, MD 20850
 Office: 301-774-0880
 Cell: 301-408-8553, FAX: 301-260-0239
 E-mail: raj@simsona.com

DRAWING TITLE:
DETAIL-001

DRAWN:	CHECKED:	APPROVED:	PAGE NO.	PR. CODE:	
DINESH	RAJ.G	RAJ.G	004	22308	
DATE:	DATE:	DATE:	SHEET NO.	SCALE:	SIZE:
12 Dec,19	-	-	4 OF 12	AS SHOWN	A3

DRAWING NUMBER:
UNC/SCH-SIMSONA-AL-DWG-DT-0401

REV: **00**

STATUS: SAMPLE DRAWING

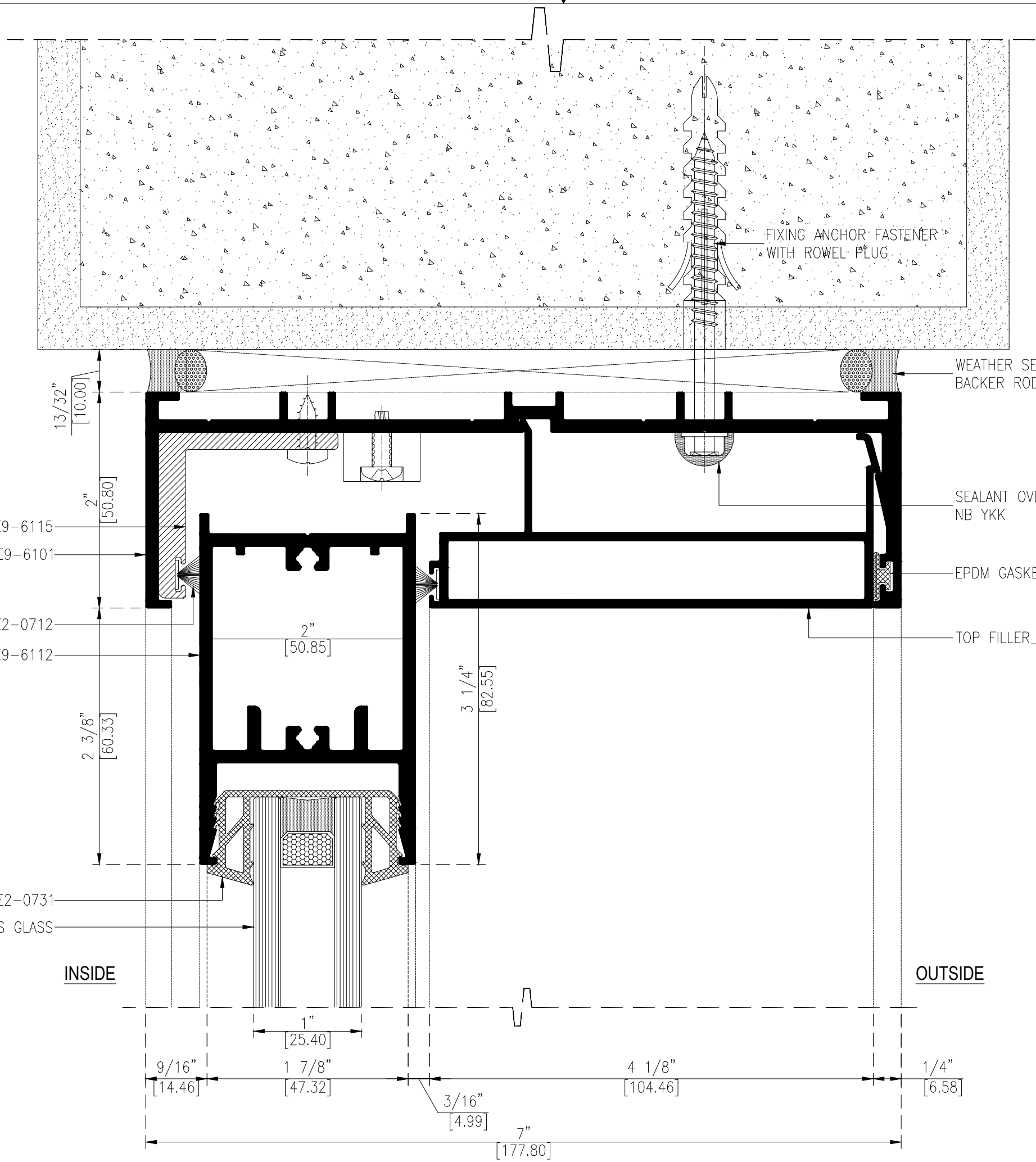

*GENERAL NOTES:
 1. ALL DIMENSION AND LEVELS ARE IN FEET INCH.
 2. ALL DIMENSIONS ARE TO BE READ NOT MEASURED.
 3. ALL ELEVATIONS VIEWED AS PER SHOWN.

REFERENCE DRAWINGS:

DESIGN DRAWING NO. REV. NO. DATE:

FACADE CONSULTANT:
JOSEPH B. CALLAGHAN, INC.
 1617 John F. Kennedy Blvd
 Suite 1655
 Philadelphia, PA 19103
 T: 215.665.0497

ARCHITECT DESIGN CONSULTANT:
KSS ARCHITECTS
 Princeton | Philadelphia
 337 Witherspoon Street
 Princeton, NJ 08542
 T: 609.921.1131

PROJECT:
UNCOMMON SCHOOL
 ADDITION AND RENOVATION
 NORTH STAR ACADEMY-571 18TH AVENUE
 571 18TH AVENUE, NEWARK, NJ 07103
 LOT 1, BLOCKS 358-359

CLIENT:
 -
 -

ISSUE

NO.	DESCRIPTION:	DATE:	REV. BY

DISCIPLINE:

FACADE CONTRACTOR:
 **SIMSONA CORPORATION**
 2275 Research Boulevard
 Suite 500
 Rockville, MD 20850
 Office: 301-774-0880
 Cell: 301-408-8553, FAX: 301-260-0239
 E-mail: raj@simsona.com

DRAWING TITLE:
DETAIL-004

DRAWN:	CHECKED:	APPROVED:	PAGE NO.	PR. CODE:	
DINESH	RAJ.G	RAJ.G	007	22308	
DATE:	DATE:	DATE:	SHEET NO.	SCALE:	SIZE:
12 Dec,19	-	-	7 OF 12	AS SHOWN	A3

DRAWING NUMBER:
UNC/SCH-SIMSONA-AL-DWG-DT-0404

REV: **00**

STATUS: SAMPLE DRAWING

DT-004 **DETAIL:**
 0301, 0303 & 0303 SCALE: 1:1

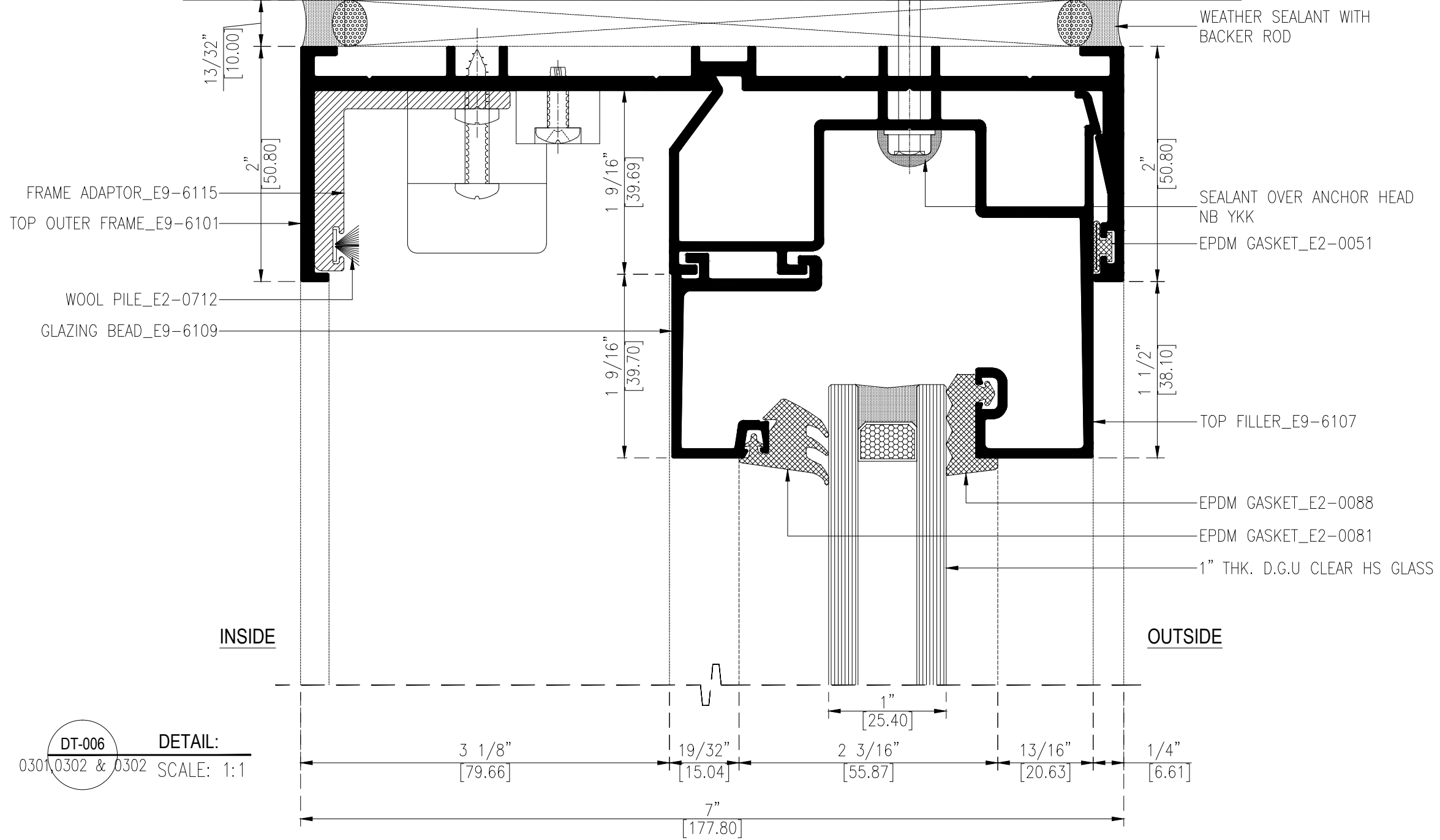
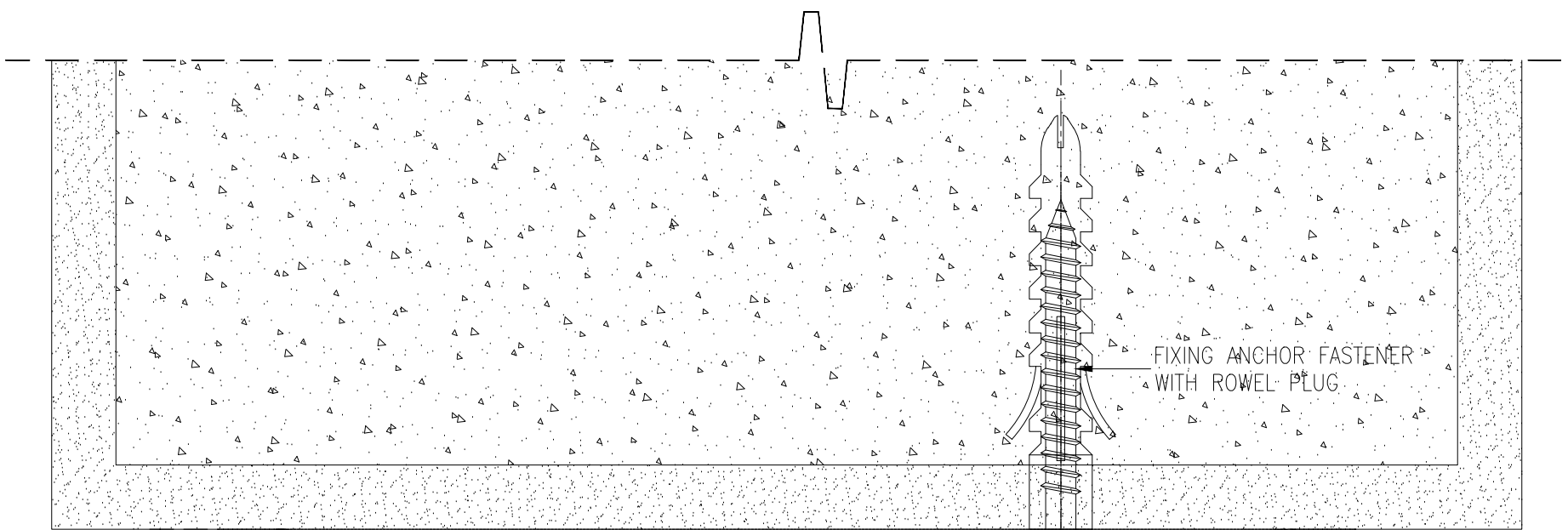

DT-006
0301, 0302 & 0302
DETAIL:
SCALE: 1:1

*GENERAL NOTES:
1. ALL DIMENSION AND LEVELS ARE IN FEET INCH.
2. ALL DIMENSIONS ARE TO BE READ NOT MEASURED.
3. ALL ELEVATIONS VIEWED AS PER SHOWN.

REFERENCE DRAWINGS:

DESIGN DRAWING NO. REV. NO. DATE:

FACADE CONSULTANT:
JOSEPH B. CALLAGHAN, INC.
1617 John F. Kennedy Blvd
Suite 1655
Philadelphia, PA 19103
T: 215.665.0497

ARCHITECT DESIGN CONSULTANT:
KSS ARCHITECTS
Princeton | Philadelphia
337 Witherspoon Street
Princeton, NJ 08542
T: 609.921.1131

PROJECT:
UNCOMMON SCHOOL
ADDITION AND RENOVATION
NORTH STAR ACADEMY-571 18TH AVENUE
571 18TH AVENUE, NEWARK, NJ 07103
LOT 1, BLOCKS 358-359

CLIENT:

ISSUE

NO.	DESCRIPTION:	DATE:	REV. BY

DISCIPLINE:

FACADE CONTRACTOR:
SIMSONA CORPORATION
2275 Research Boulevard
Suite 500
Rockville, MD 20850
Office: 301-774-0880
Cell: 301-408-8553, FAX: 301-260-0239
E-mail: raj@simsona.com

DRAWING TITLE:
DETAIL-006

DRAWN:	CHECKED:	APPROVED:	PAGE NO.	PR. CODE:	
DINESH	RAJ.G	RAJ.G	009	22308	
DATE:	DATE:	DATE:	SHEET NO.	SCALE:	SIZE:
12 Dec,19			9 OF 12	AS SHOWN	A3

DRAWING NUMBER:
UNC/SCH-SIMSONA-AL-DWG-DT-0406

STATUS: SAMPLE DRAWING

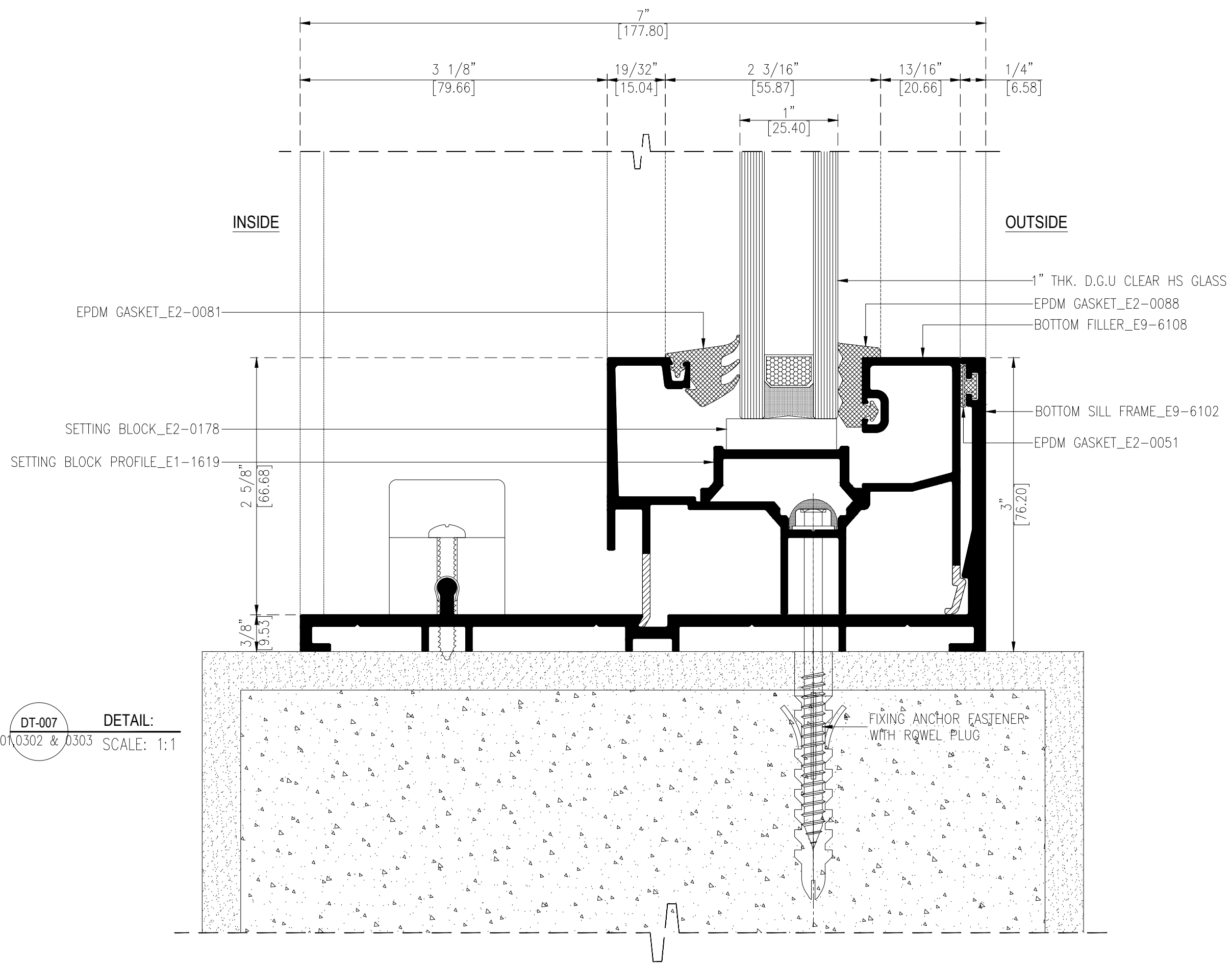

*GENERAL NOTES:
 1. ALL DIMENSION AND LEVELS ARE IN FEET INCH.
 2. ALL DIMENSIONS ARE TO BE READ NOT MEASURED.
 3. ALL ELEVATIONS VIEWED AS PER SHOWN.

REFERENCE DRAWINGS:

—	—	—
—	—	—
—	—	—
—	—	—
—	—	—
—	—	—
—	—	—
—	—	—
—	—	—
—	—	—

DESIGN DRAWING NO. REV. NO. DATE:

FACADE CONSULTANT:
JOSEPH B. CALLAGHAN, INC.
 1617 John F. Kennedy Blvd
 Suite 1655
 Philadelphia, PA 19103
 T: 215.665.0497

ARCHITECT DESIGN CONSULTANT:
KSS ARCHITECTS
 Princeton | Philadelphia
 337 Witherspoon Street
 Princeton, NJ 08542
 T: 609.921.1131

PROJECT:
UNCOMMON SCHOOL
 ADDITION AND RENOVATION
 NORTH STAR ACADEMY-571 18TH AVENUE
 571 18TH AVENUE, NEWARK, NJ 07103
 LOT 1, BLOCKS 358-359

CLIENT:
 —

ISSUE

—	—	—	—
—	—	—	—
—	—	—	—
—	—	—	—
—	—	—	—
—	—	—	—
—	—	—	—
—	—	—	—
—	—	—	—
—	—	—	—

NO. DESCRIPTION: DATE: REV.BY

DISCIPLINE:

FACADE CONTRACTOR:
 **SIMSONA CORPORATION**
 2275 Research Boulevard
 Suite 500
 Rockville, MD 20850
 Office: 301-774-0880
 Cell: 301-408-8553, FAX: 301-260-0239
 E-mail: raj@simsona.com

DRAWING TITLE:
DETAIL-007

DRAWN:	CHECKED:	APPROVED:	PAGE NO.	PR. CODE:	
DINESH	RAJ.G	RAJ.G	010	22308	
DATE:	DATE:	DATE:	SHEET NO.	SCALE:	SIZE:
12 Dec,19	—	—	10 OF 12	AS SHOWN	A3
DRAWING NUMBER:					REV:
UNC/SCH-SIMSONA-AL-DWG-DT-0407					00
STATUS: SAMPLE DRAWING					

DT-007 DETAIL:
 0301,0302 & 0303 SCALE: 1:1

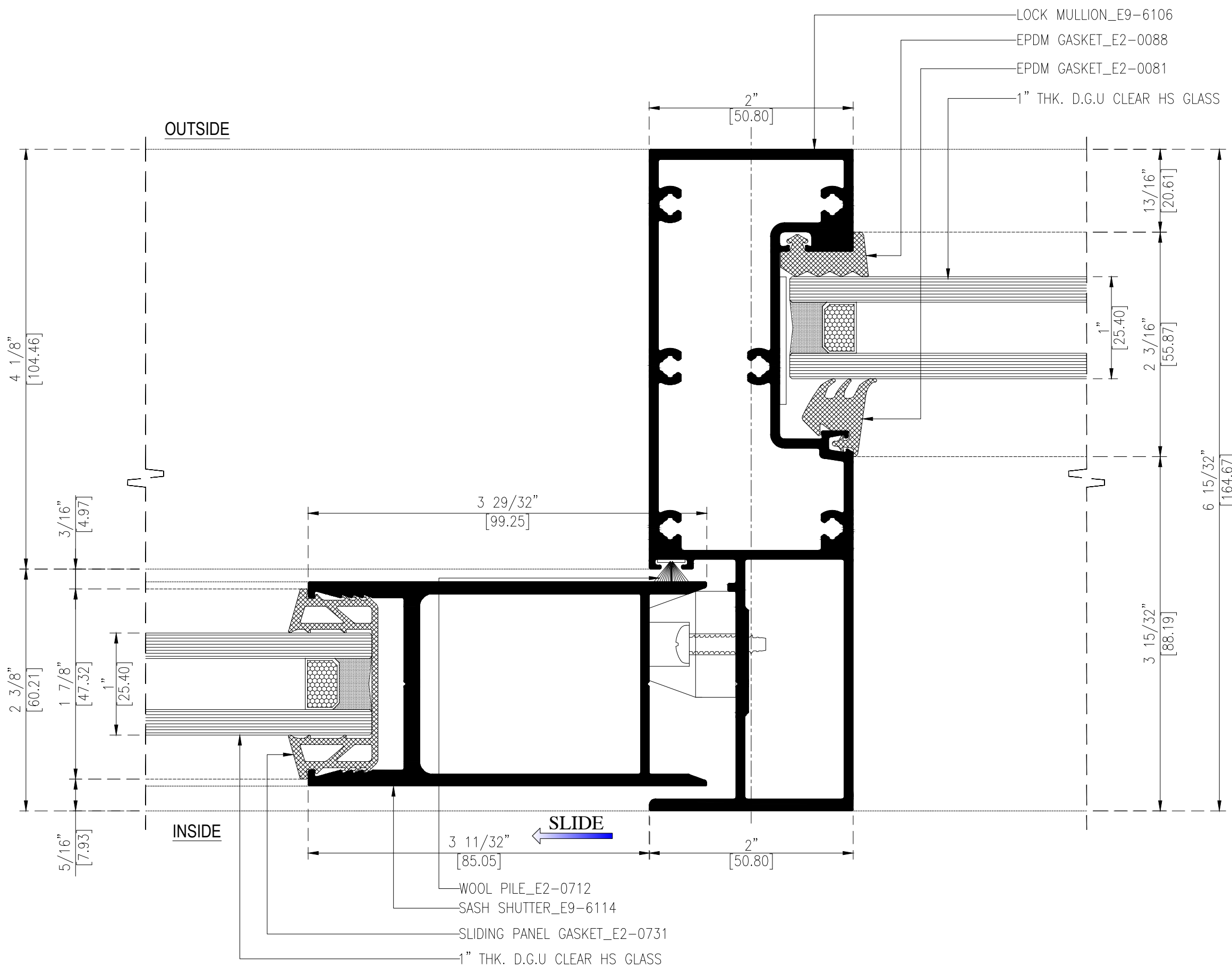

*GENERAL NOTES:
 1. ALL DIMENSION AND LEVELS ARE IN FEET INCH.
 2. ALL DIMENSIONS ARE TO BE READ NOT MEASURED.
 3. ALL ELEVATIONS VIEWED AS PER SHOWN.

REFERENCE DRAWINGS:

DESIGN DRAWING NO. REV. NO. DATE:

FACADE CONSULTANT:
JOSEPH B. CALLAGHAN, INC.
 1617 John F. Kennedy Blvd
 Suite 1655
 Philadelphia, PA 19103
 T: 215.665.0497

ARCHITECT DESIGN CONSULTANT:
KSS ARCHITECTS
 Princeton | Philadelphia
 337 Witherspoon Street
 Princeton, NJ 08542
 T: 609.921.1131

PROJECT:
UNCOMMON SCHOOL
 ADDITION AND RENOVATION
 NORTH STAR ACADEMY-571 18TH AVENUE
 571 18TH AVENUE, NEWARK, NJ 07103
 LOT 1, BLOCKS 358-359

CLIENT:
 -
 -

ISSUE

NO.	DESCRIPTION:	DATE:	REV. BY

DISCIPLINE:

FACADE CONTRACTOR:
 **SIMSONA CORPORATION**
 2275 Research Boulevard
 Suite 500
 Rockville, MD 20850
 Office: 301-774-0880
 Cell: 301-408-8553, FAX: 301-260-0239
 E-mail: raj@simsona.com

DRAWING TITLE:
DETAIL-008

DRAWN:	CHECKED:	APPROVED:	PAGE NO.	PR. CODE:	
DINESH	RAJ.G	RAJ.G	011	22308	
DATE:	DATE:	DATE:	SHEET NO.	SCALE:	SIZE:
12 Dec,19	-	-	11 OF 12	AS SHOWN	A3

DRAWING NUMBER:
UNC/SCH-SIMSONA-AL-DWG-DT-0408

REV:
00

STATUS: SAMPLE DRAWING

DT-008 **DETAIL:**
 0302 SCALE: 1:1

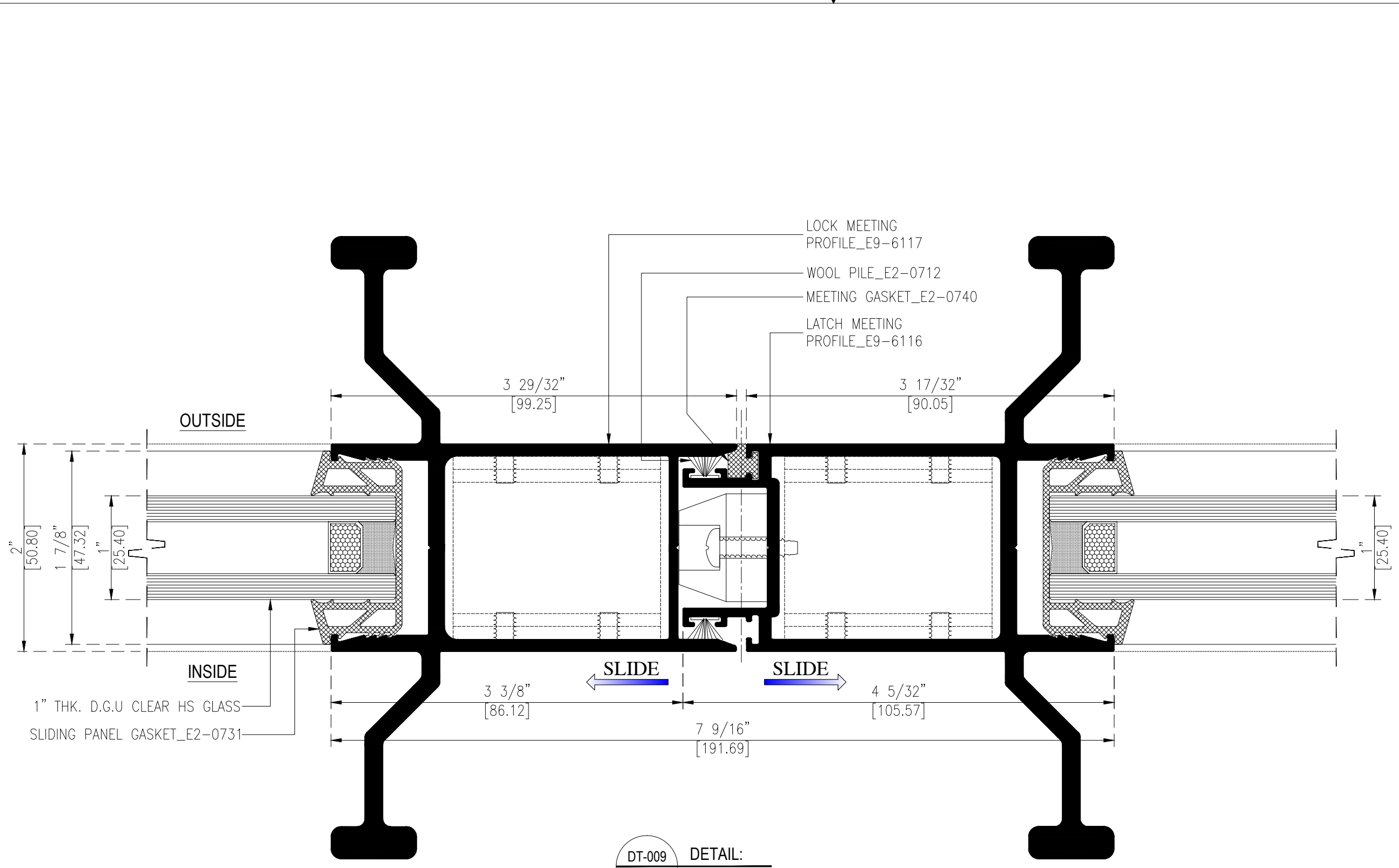

*GENERAL NOTES:
 1. ALL DIMENSION AND LEVELS ARE IN FEET INCH.
 2. ALL DIMENSIONS ARE TO BE READ NOT MEASURED.
 3. ALL ELEVATIONS VIEWED AS PER SHOWN.

REFERENCE DRAWINGS:

---	---	---
---	---	---
---	---	---
---	---	---
---	---	---
---	---	---
---	---	---
---	---	---
---	---	---
---	---	---

DESIGN DRAWING NO. REV. NO. DATE:

FACADE CONSULTANT:
JOSEPH B. CALLAGHAN, INC.
 1617 John F. Kennedy Blvd
 Suite 1655
 Philadelphia, PA 19103
 T: 215.665.0497

ARCHITECT DESIGN CONSULTANT:
KSS ARCHITECTS
 Princeton | Philadelphia
 337 Witherspoon Street
 Princeton, NJ 08542
 T: 609.921.1131

PROJECT:
UNCOMMON SCHOOL
 ADDITION AND RENOVATION
 NORTH STAR ACADEMY-571 18TH AVENUE
 571 18TH AVENUE, NEWARK, NJ 07103
 LOT 1, BLOCKS 358-359

CLIENT:
 -
 -

ISSUE

---	---	---
---	---	---
---	---	---
---	---	---
---	---	---
---	---	---
---	---	---
---	---	---
---	---	---
---	---	---

NO.	DESCRIPTION:	DATE:	REV. BY

DISCIPLINE:

FACADE CONTRACTOR:
 **SIMSONA CORPORATION**
 2275 Research Boulevard
 Suite 500
 Rockville, MD 20850
 Office: 301-774-0880
 Cell: 301-408-8553, FAX: 301-260-0239
 E-mail: raj@simsona.com

DRAWING TITLE:

DETAIL-009

DRAWN:	CHECKED:	APPROVED:	PAGE NO.	PR. CODE:	
DINESH	RAJ.G	RAJ.G	012	22308	
DATE:	DATE:	DATE:	SHEET NO.	SCALE:	SIZE:
12 Dec,19	-	-	12 OF 12	AS SHOWN	A3

DRAWING NUMBER:
UNC/SCH-SIMSONA-AL-DWG-DT-0409 REV: **00**

STATUS: SAMPLE DRAWING